

Amsino Waste Fluid Management Solutions



RECEPTAL®
Suction Liner System

RECEPTAL® *Twist*
Solidifier Integrated
Suction Liner System

RECEPTAL®
Solidifiers

EZE-VAC®
Rigid Suction Canister
System

ACCU-MEASURE®
Critical Measurement
Canister

AMSure®
Suction Tubing,
Yankauers, Handles
and Catheters

STERiCADI™
Suction Device Holder

AMSINO

Advancing Healthcare Worldwide®

Amsino Waste Fluid Management Solutions



RECEPTAL®

Suction Liner System

The RECEPTAL Suction Liner System is one of the safest systems in waste fluid collection. This system combines the benefits of both a reusable canister and a disposable liner with permanently attached lid and tubing, simplifying set up time, reducing costs and providing additional protection.

RECEPTAL Liners and EZE-VAC Canisters include an anti-foaming emulsion that prevents froth formation and aerosolization, reducing the risk of contaminant exposure while maximizing fluid capacity. These efficient systems securely isolate suction waste with single, dual and multiple configurations that provide fluid capacity up to 24L without disconnection.

Both systems support best practice by integrating VAC-GARD®, a non-mechanical shut-off valve that prevents back flow of aerosols and fluids into the vacuum system, and includes a 0.3 micron bacterial eliminating filter effective in removing 99.9% of pseudomonas.



EZE-VAC®

Rigid Suction Canister System

The EZE-VAC Rigid Suction Canister System is single-use, designed for convenience by removing the need for a secondary waste liner. The canister and lid provide a vacuum tight seal at room temperature, improving suction performance and reducing risk during disposal. The lid ports are clearly marked and come with pre-attached elbows to simplify set up.

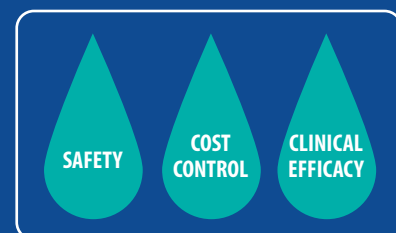

Table of Contents

RECEPTAL® Outer Shells	1
RECEPTAL Liners.....	2
RECEPTAL Twist Liners	3
RECEPTAL Solidifiers.....	4
EZE-VAC Canisters	5
EZE-VAC® 2.0 Suction Canister System	6
ACCU-MEASURE® Critical Measurement Devices	7
AMSure® Suction Yankauers	8
STERICADI™ Suction Device Holster System	9
AMSure Suction Tubing	10
RECEPTAL and EZE-VAC Accessories.....	11, 12, 13
Suction Catheters and Trays	14
Suction Catheter Kits	15
RECEPTAL and EZE-VAC Reusable Hardware.....	16, 17, 18
Regulator Mounts	18
Installation Procedures.....	19-29
Uninstallation Procedures	30
Index	31, 32

Amsino is a leading global provider of waste fluid management systems. For over a decade, Amsino has been manufacturing a wide range of suction products to the highest quality standards and has developed some of the most advanced waste fluid management systems in the world.

RECEPTAL Waste Fluid Management Systems help hospitals manage suction waste by providing, Simple, Safe and Complete Solutions.

- **Complete Suction System**
- **Highest Quality and Reliability**
- **Superior Bacterial Filtration Efficiency**
- **Easy to Use**
- **Cost Saving**
- **Professional Advice, Guidance and Training on Waste Fluid Management**



Advancing Healthcare Worldwide®

RECEPTAL® Outer Shells

RECEPTAL Outer Shells are designed with durability and efficiency in mind. The reusable canister is to be used with the same size RECEPTAL Disposable Liner.

- Easy to read volume marks
- Large patient label strip for convenient documentation
- Non-sterile, DEHP-free, PVC-free, not manufactured with natural rubber latex



The canister ring seal firmly secures the liner lid to the canister, maximizing vacuum power to provide the best clinical outcomes.



Large, easy to read volume marks in 25 mL increments help with patient documentation.



Canister “T” designates vacuum source connection to simplify canister set up.



Color-coded by size for easy selection.

ITEM CODE	DESCRIPTION	QTY/UNIT
43449-05	1000 mL Outer Shell	10/Case
43423-01	1500 mL Outer Shell	10/Case
43445-01	2000 mL Outer Shell	10/Case
43503-01	3000 mL Outer Shell	8/Case

RECEPTAL® Liners

RECEPTAL Disposable Liners are designed with permanently attached lids and a multifunctional lid tube which help decrease the risk of fluid exposure. RECEPTAL Liners are to be used with the same size RECEPTAL Outer Shells.

- Anti-foaming emulsion helps prevent froth formation and aerosolization, reducing the risk of contaminant exposure
- 100% leak tested seamless liners minimize risk of contamination
- Non-sterile, BPA-free, not manufactured with natural rubber latex

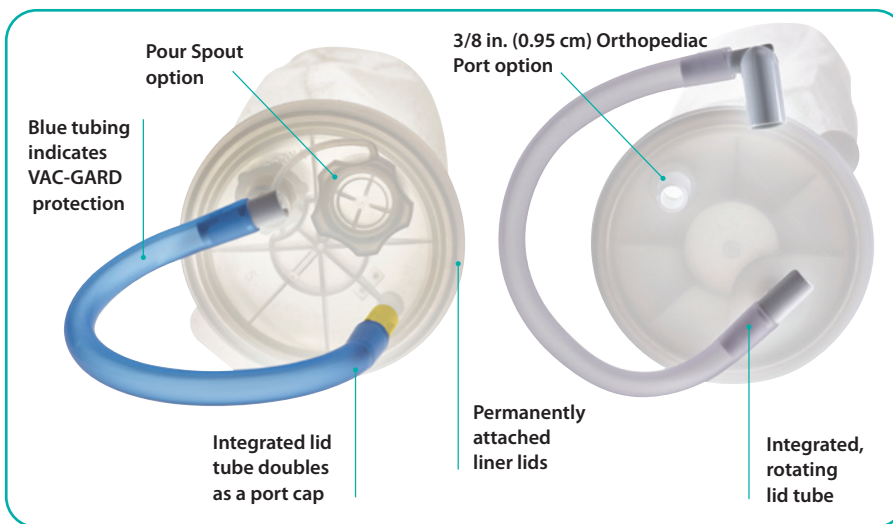

SIZE (mL)	ITEM CODE	FEATURES	QTY/UNIT
1,000	43010-05	VAC-GARD and Pour Spout	50/Case
	43010S	VAC-GARD and 30g Solidifier	50/Case
1,500	43025-01	Pour Spout	50/Case
	43044-01	VAC-GARD and Pour Spout	50/Case
	43015S	VAC-GARD and 45g Solidifier	50/Case
2,000	43027-01	Pour Spout	50/Case
	43041-01	Ortho Port	50/Case
	43042-01	VAC-GARD	50/Case
	43044-05	VAC-GARD and Pour Spout	50/Case
	43020S	VAC-GARD and 60g Solidifier	50/Case
3,000	0L656-01*	Dual Ports (Ortho + Standard) and Pour Spout	50/Case
	0L655-01*	VAC-GARD, Dual Ports (Ortho + Standard) and Pour Spout	50/Case
	43030S*	VAC-GARD and 90g Solidifier	50/Case

* Dual port allows for dual suctioning during procedures.

Standard Port = 5/16" (7.9mm) OD, 1/4" (6.4mm) ID; Ortho Port = 3/8" (9.6mm) OD, 5/16" (7.8mm) ID

RECEPTAL® *Twist* Liners

The RECEPTAL Twist liner is a patented all-in-one waste fluid collection and solidifier solution available in 1.5 and 2 L sizes, in both VAC-GARD® and non-VAC-GARD options.

After a procedure, simply twist the integrated and preloaded Solidifier Dispenser Cap at the top of the lid clockwise 180° to easily and safely release solidifier into the liner. The Twist eliminates the need to open ports, creating a closed system where waste fluid is safe, sealed, solid and ready for disposal.

- **Premeasured, preloaded and contact-free Solidifier Dispenser Cap**
- **Integrated solidifier eliminates the need for open ports**
- **All-in-one solidifier and liner solution reduces costs associated with extra inventory**
- **100% leak tested seamless liners minimize risk of contamination**
- **Non-sterile, BPA-free, not manufactured with natural rubber latex**

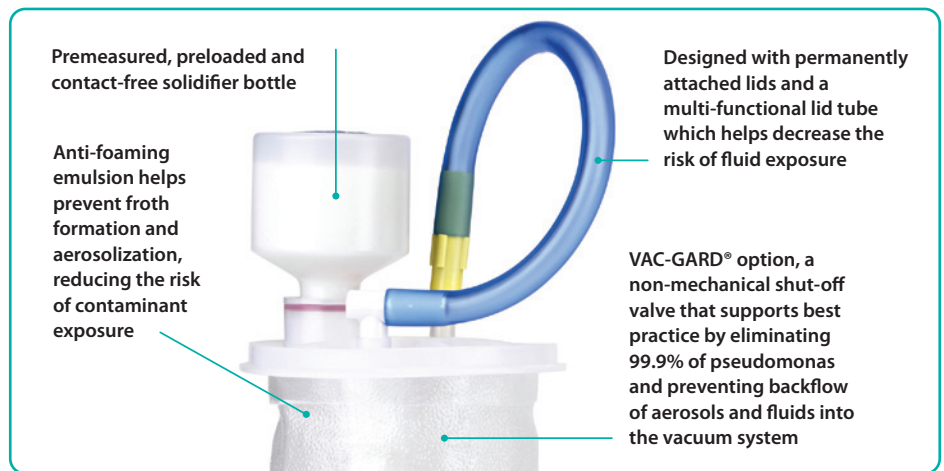

ITEM CODE	DESCRIPTION	QTY/UNIT
43110S	1000 mL Liner with VAC-GARD and Pre-attached Solidifier Dispenser Cap	40/Case
43115S	1500 mL Liner with VAC-GARD and Pre-attached Solidifier Dispenser Cap	40/Case
43116S	1500 mL Liner with Pre-attached Solidifier Dispenser Cap	40/Case
43120S	2000 mL Liner with VAC-GARD and Pre-attached Solidifier Dispenser Cap	40/Case
43121S	2000 mL Liner with Pre-attached Solidifier Dispenser Cap	40/Case

RECEPTAL® Solidifiers

RECEPTAL Solidifier Bottles and Dissolvable Pouches effectively solidify potentially serious infectious waste within the suction canister. It penetrates rapidly throughout the canister/liner to solidify blood and body fluids and gels. It retains solidity to help prevent spills and leaks for safe and easy bagging and transport to disposal.

- **No shaking required**
- **Multiple sizes to match any need**
- **Dissolvable pouch option eliminates plastic bottle waste**
- **Chlorine-free for non-toxic incineration**
- **Not made with natural rubber latex**



RECEPTAL Solidifier Pouches

ITEM CODE	DESCRIPTION	QTY/UNIT
4305SP	500 Solidifier Pouch, solidifies 500 mL	96/Case
4312SP	1200 Solidifier Pouch, solidifies 1200 mL	96/Case
4315SP	1500 Solidifier Pouch, solidifies 1500 mL	96/Case
4320SP	2000 Solidifier Pouch, solidifies 2000 mL	96/Case
4330SP	3000 Solidifier Pouch, solidifies 3000 mL	96/Case

RECEPTAL Solidifier Bottles

ITEM CODE	DESCRIPTION	QTY/UNIT
4305SB	500 Solidifier Bottle, solidifies 500 mL	96/Case
4312SB	1200 Solidifier Bottle, solidifies 1200 mL	96/Case
4315SB	1500 Solidifier Bottle, solidifies 1500 mL	96/Case
4320SB	2000 Solidifier Bottle, solidifies 2000 mL	96/Case
4330SB	3000 Solidifier Bottle, solidifies 3000 mL	96/Case
43160SB	16000 Solidifier Bottle, solidifies up to 16,000 mL	20/Case



EZE-VAC® Canisters

EZE-VAC suction canisters are a single-use disposable, designed for convenience by removing the need for a secondary waste liner. The canisters include VAC-GARD®, a non-mechanical shut-off valve that supports best practice by eliminating 99.9% of pseudomonas and preventing backflow of aerosols and fluids into the vacuum system.

- **Easy-to-read volume marks**
- **Reflux protector on patient port reduces contamination exposure risk**
- **Non-sterile, DEHP-free, BPA-free, not manufactured with natural rubber latex**



ITEM CODE	DESCRIPTION	QTY/UNIT
43203-01	1200 mL Canister, Lid and 2 Elbows	32/Case
43206-01	2000 mL Canister, Lid and 2 Elbows	24/Case
43213-01	3300 mL Canister, Lid and 2 Elbows	12/Case

EZE-VAC® 2.0 Suction Canister System



The new EZE-VAC 2.0 suction canister system is very economical and compatible with most hardware in the market. This canister system also includes VAC-GARD® non-mechanical shut-off valve and an anti-foaming emulsion that prevents froth formation and aerosolization, reducing the risk of contaminant exposure while maximizing fluid capacity.

- **Easy-to-read volume marks**
- **VAC-GARD eliminates 99.9% of pseudomonas and protects the vacuum system from fluids**
- **Compatible with most hardware in the market**
- **Non-sterile, DEHP-free, BPA-free, not manufactured with natural rubber latex**

ITEM CODE	DESCRIPTION	QTY/UNIT
43210-01	800 mL EZE-VAC 2.0 Canister and Lid	32/Case
43202-01	1200 mL EZE-VAC 2.0 Canister and Lid	32/Case
43202-820821	1200 mL EZE-VAC 2.0 Canister Procedure Kit with Non-sterile Suction Tube 3/16 in. ID x 6 ft. (5 mm x 1.8 m) + 3/16 in ID x 18 in. (5 mm x 46 cm)	30/Case

ACCU-MEASURE® Critical Measurement Canisters

ACCU-MEASURE critical measurement canisters enable the user to make contact-free critical measurements of smaller quantities of aspirate (i.e. during pediatric procedures).

The RECEPTAL® ACCU-MEASURE is a disposable, tapered 250 mL critical measurement canister calibrated to scale. Graduations in 5 mL increments from 0 to 50 mL, 10 mL increments from 50 mL to 150 mL and 20 mL increments from 150 mL to 250 mL.

- **Non-sterile, BPA-free, not manufactured with natural rubber latex**



RECEPTAL ACCU-MEASURE complete installation



5 mL increments from 0 to 50 mL



ITEM CODE	DESCRIPTION	FEATURES	QTY/UNIT
43306-01	250 mL Critical Measurement Canister	Tandem Tube	12/Case
43305-10	Canister Attachment Bracket for 250 mL Canister	Compatible with 1000 mL, 1500 mL and 2000 mL RECEPTAL Canisters	10/Case

AMSure® Suction Yankauers

The AMSure Suction Yankauer Collection is designed with shatter-resistant materials. The slip-resistant, lightweight handle helps provide optimal control and maneuverability. A translucent pathway allows for fluid visualization and the smooth tips are designed with side eyes to minimize the chance of tissue grab and damage.

- Sterile vented and non-vented
- Rigid and flexible handles



Regular and Bulbous Tips



Non-Vented and Vented

Yankauers

DESCRIPTION			STERILE	NON-STERILE
Rigid	Regular Beveled Tip	Non-Vented	AS830 50/Case	AS830B 500/Case
Rigid	Regular Beveled Tip	Vented	AS831 50/Case	AS831B 500/Case
Rigid	Bulbous Tip	Non-Vented	AS832 50/Case	AS832B 500/Case
Rigid	Bulbous Tip	Vented	AS833 50/Case	AS833B 500/Case
Flexible	Regular Beveled Tip	Non-Vented	AS834 50/Case	AS834B 500/Case
Flexible	Regular Beveled Tip	Vented	AS835 50/Case	AS835B 500/Case
Flexible	Bulbous Tip	Non-Vented	AS836 50/Case	AS836B 500/Case
Flexible	Bulbous Tip	Vented	AS837 50/Case	AS837B 500/Case

Yankauer & Tubing Kits

ITEM CODE	DESCRIPTION	QTY/UNIT
AS825P	Rigid Yankauer, Bulbous Tip, Non-Vented, pre-attached to 1/4 in. (6 mm) × 6 ft. (1.8 m) Suction Tubing, Sterile	50/Case
AS827P*	Rigid Yankauer, Non-Vented with Bulbous Tip, pre-attached to 1/4 in. (6 mm) × 12 ft. (3.7 m) Suction Tubing, Sterile	50/Case

*Made to order

STERiCADI™ Suction Device Holster System

SteriCadi™ is a sterile disposable holder to store suction devices. The intuitive design is easy to set up and use to help support better infection control outcomes.

- Suction devices can be isolated to help reduce cross-contamination and improve safety measures
- Sterile, DEHP-free, BPA-free, not manufactured with natural rubber latex

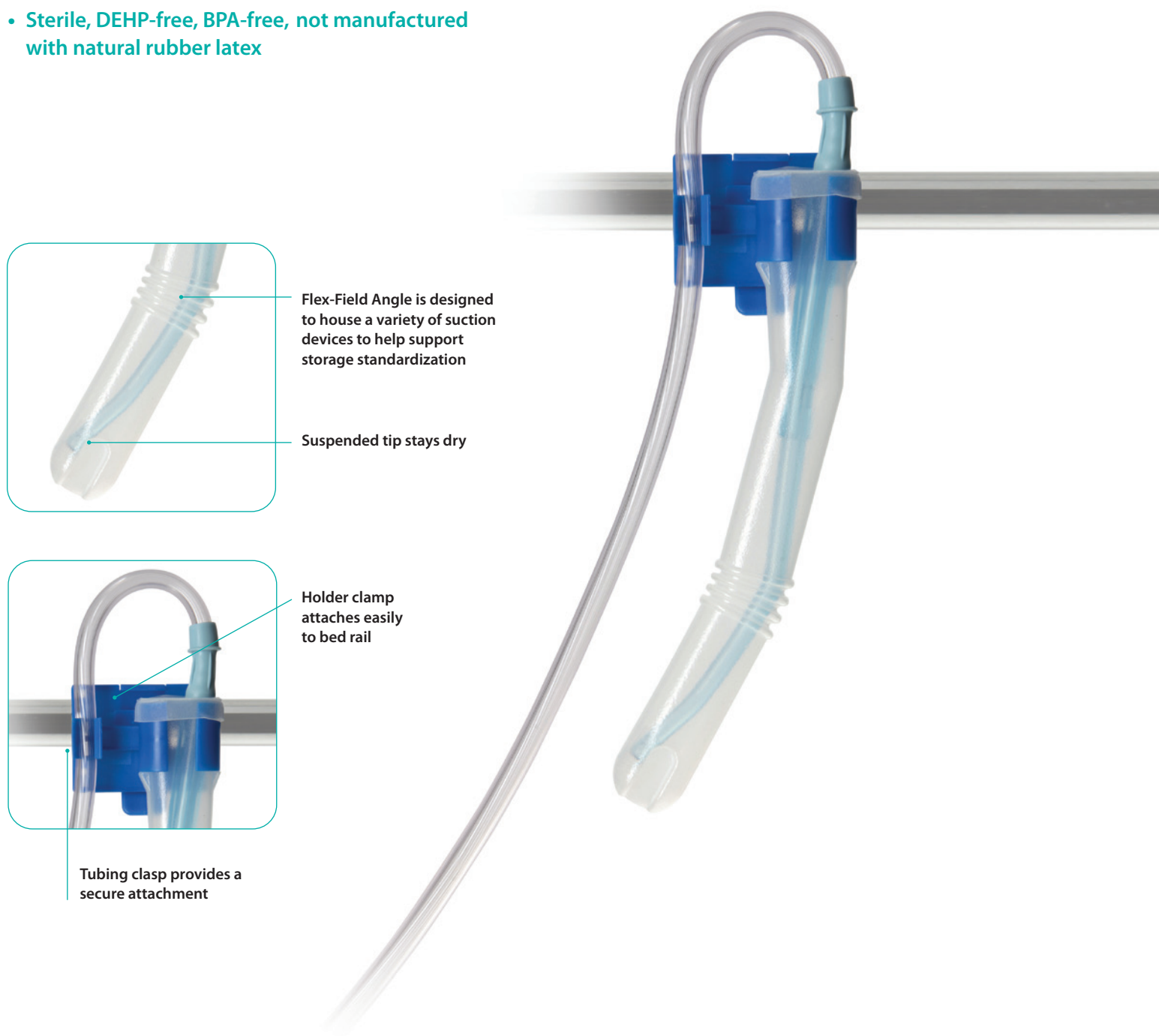

ITEM CODE	DESCRIPTION	QTY/UNIT
SIH0001	SteriCadi Suction Device Holder, Sterile	30/Case

AMSure® Suction Tubing with Connectors

AMSure Suction Tubing, with molded female connectors and male adapters, provide secure connections to support uninterrupted procedures. Flexible, low-coil memory allows for easy draping.

- Sterile and non-sterile options, BPA-free, not manufactured with natural rubber latex



DIAMETER (ID)	LENGTH	STERILE	NON-STERILE
3/16 in. (5 mm) Green Connectors	18 in. (46 cm)	AS820 (50/Case)	AS820B (100/Case)
	6 ft. (1.8 m)	AS821 (50/Case)	AS821B (50/Case)
	10 ft. (3.0 m)	AS822 (50/Case)	AS822B (50/Case)
	12 ft. (3.7 m)	AS823 (20/Case)	AS823B (50/Case)
	20 ft. (6.1 m)	AS824 (20/Case)	AS824B (50/Case)
1/4 in. (6 mm) Light Blue Connectors	6 ft. (1.8 m)	AS825 (50/Case)	AS825B (50/Case)
	10 ft. (3.0 m)	AS826 (50/Case)	AS826B (50/Case)
	10 ft. (6 mm × 3.0 m) with Pinch Clamps	AS826C (50/Case)	—
	12 ft. (3.7 m)	AS827 (20/Case)	AS827B (50/Case)
	20 ft. (6.1 m)	AS828 (20/Case)	AS828B (50/Case)
	100 ft. (30.0 m) with Connectors every 6 ft. (1.8 m)	—	AS829B-01 (1 Roll/Case)
9/32 in. (7 mm) Dark Blue Connectors	6 ft. (1.8 m)	AS825M (50/Case)	AS825BM (50/Case)
	10 ft. (3.0 m)	AS826M (50/Case)	AS826BM (50/Case)
	12 ft. (3.7 m)	AS827M (20/Case)	AS827BM (50/Case)
	20 ft. (6.1 m)	AS828M (20/Case)	AS828BM (50/Case)

RECEPTAL® & EZE-VAC® Accessories



RECEPTAL Specimen Traps

RECEPTAL Specimen Traps safely collect and retain specimens for analysis. The traps are compatible with RECEPTAL and EZE-VAC lids with a pour spout.

- **Pour spout cover provides a tight seal to ensure proper suction**
- **Specimen traps with stiffener offer simplified insertion into the collection port**
- **Non-sterile, disposable, DEHP-free, BPA-free, not manufactured with natural rubber latex**

ITEM CODE	DESCRIPTION	FEATURES		QTY/UNIT
		Suction Port Size	Stiffener	
43303-01	4 in. (10.16 cm), Pour Spout Cover and Tethered Cap	3/8 in. (0.95 cm)		24/Case
43303-02	4 in. (10.16 cm), Pour Spout Cover and Tethered Cap	3/8 in. (0.95 cm)	•	24/Case
43303-05	8 in. (20.32 cm), Pour Spout Cover and Tethered Cap	1/2 in. (1.27 cm)	•	24/Case



External VAC-GARD® Shut-Off Valve

VAC-GARD external non-mechanical shut-off valve helps support best practice by eliminating 99.9% of pseudomonas and preventing backflow of aerosols and fluids into the vacuum system.

- **Non-sterile, disposable, DEHP-free, BPA-free, not manufactured with natural rubber latex**

ITEM CODE	DESCRIPTION	QTY/UNIT
43309-01	External Shut-Off Valve, ¼ in. (0.64 cm) Male x Female Elbow	10/Case



RECEPTAL Accu-Measure® Device Bracket

This bracket is used to secure 250 mL canister (43306-01) to a RECEPTAL Reusable Canister. Compatible with 1000 mL, 1500 mL and 2000 mL RECEPTAL Canisters.

ITEM CODE	DESCRIPTION	QTY/UNIT
43305-10	Canister Attachment Bracket for 250 mL Canister	10/Case

RECEPTAL® & EZE-VAC® Accessories

Suction Tubing

For permanent Outer Shell-to-vacuum source, or Outer Shell-to-Outer Shell connections.

ITEM CODE	DESCRIPTION	QTY/UNIT
43455-01	100 ft. (30.48 m) PVC Non-Sterile Suction Tubing 9/32 in. (7 mm) I.D.	1/Case
43457-25	24 in. (0.61 m) PVC Non-Sterile Suction Tubing 9/32 in. (7 mm) I.D.	25/Case



EZE-VAC Tandem Tubing

EZE-VAC Tandem disposable tubing allows two or more EZE-VAC canisters to work together to meet procedural requirements.

- **Non-sterile, BPA-free, not manufactured with natural rubber latex**

ITEM CODE	DESCRIPTION	QTY/UNIT
43317-25	18 in. (0.45 m) Tandem Tubing	25/Case



RECEPTAL Outer Shell Connection Tubing

RECEPTAL Outer Shell connection disposable tubing allows to easily connect the vacuum "T" of the RECEPTAL canisters between them for easy tandem connection.

ITEM CODE	DESCRIPTION	QTY/UNIT
CTM50B	1/4 in. x 20 in. (6.35 mm x 500 mm), Female Connector	100/Case
CTM20B	1/4 in. x 8 in. (6.35 mm x 200 mm), Female Connector	300/Case



Tubing Manifold

For connection of 2, 3 or 4 canisters.

ITEM CODE	DESCRIPTION	QTY/UNIT
TMF001	Tubing Manifold	10/Case



RECEPTAL® & EZE-VAC® Accessories

RECEPTAL Elbow Adapters and Taper

Use with Patient Port.



ITEM CODE	DESCRIPTION	QTY/UNIT
43318-01	1/4 in. (0.64 cm) Male x Female Elbow (use with 3/8 in. (0.95 cm) Orthopedic Port)	100/Case
43316-01	1/4 in. (0.64 cm) Male x Female Elbow	100/Case
43494-25	1/4 in. (0.64 cm) Male x Female Elbow	25/Case
43473-25	Double 1/4 in. (0.64 cm) Male Taper (use with 3/8 in. (0.95 cm) Orthopedic Port)	25/Case

RECEPTAL Outer Shell Parts

Attach to Canister for vacuum suction.



ITEM CODE	DESCRIPTION	QTY/UNIT
44300-05	T, Double Male 1/4 in. (0.64 cm) with O-Ring and Screw	5/Case
43448-25	Taper, Male 1/4 in. (0.64 cm) x Female (use with Canister Vacuum "T")	25/Case

5-in-1 Straight Connector

AMSure® 5-in-1 Connector is a durable connector used to connect same size tubing or use as a reducer and fits five (3/16 in., 1/4 in., 5/16 in., 3/8 in., 7/16 in.) sizes of tubing.

- **DEHP-free, BPA-free, not manufactured with natural rubber latex**



ITEM CODE	DESCRIPTION	QTY/UNIT
AS807	5-in-1 Connector, Sterile	100/Case
AS807B	5-in-1 Connector, Non-sterile	500/Case

6-in-1 Universal Y Connector

Lightweight, durable polypropylene plastic connectors adapt for almost any use allowing for multiple pieces of tubing to be joined together. Tapered legs fit six sizes of tubing, from 6 mm to 15 mm (1/4 in. to 9/16 in.).

- **DEHP-free, BPA-free, not manufactured with natural rubber latex**



ITEM CODE	DESCRIPTION	QTY/UNIT
UYC001S	6-in-1 Universal Y Connector, Sterile	100/Case
UYC001	6-in-1 Universal Y Connector, Non-sterile	500/Case

Suction Catheters and Trays

Suction Catheters

AMSure® Suction Catheters improve patient care by safely removing respiratory secretions from the upper airway. The suction catheters are available in both straight and coiled packs in various French sizes.

- **Opposing staggered eyelets reduce the potential for blocked suction**
- **Whistle cap port enhances controlled suction**
- **Sterile, latex-free and BPA-free**



ITEM	DESCRIPTION	FEATURES	QTY/UNIT
AS361	6 Fr, 17 ½ in. (44.5 cm)	Straight Pack	50/Case
AS361C	6 Fr, 17 ½ in. (44.5 cm)	Coiled Pack	50/Case
AS362	8 Fr, 17 ½ in. (44.5 cm)	Straight Pack	50/Case
AS362C	8 Fr, 17 ½ in. (44.5 cm)	Coiled Pack	50/Case
AS363	10 Fr, 23 in. (58.4 cm)	Straight Pack	50/Case
AS363C	10 Fr, 23 in. (58.4 cm)	Coiled Pack	50/Case
AS364	12 Fr, 23 in. (58.4 cm)	Straight Pack	50/Case
AS364C	12 Fr, 23 in. (58.4 cm)	Coiled Pack	50/Case
AS365	14 Fr, 23 in. (58.4 cm)	Straight Pack	50/Case
AS365C	14 Fr, 23 in. (58.4 cm)	Coiled Pack	50/Case
AS366	16 Fr, 23 in. (58.4 cm)	Straight Pack	50/Case
AS366C	16 Fr, 23 in. (58.4 cm)	Coiled Pack	50/Case
AS367	18 Fr, 23 in. (58.4 cm)	Straight Pack	50/Case
AS367C	18 Fr, 23 in. (58.4 cm)	Coiled Pack	50/Case

Mini Suction Catheter Trays

The AMSure® Mini Suction Catheter Trays' space-saving design offers everything needed for effective procedures. The mini tray serves as a basin to hold sterile water or saline.

- **Opposing staggered eyelets reduce the potential for blocked suction**
- **DeLee Tip's smooth and rounded tip minimizes trauma for pediatric patients**
- **Whistle tip enhances controlled suction**
- **Sterile, BPA-free, not manufactured with natural rubber latex**



ITEM CODE	DESCRIPTION	CATHETER SIZE	FEATURES	QTY/UNIT
SCT08	Tray, Vinyl Gloves and 17 ½ in. Suction Catheter	8 Fr	DeLee Tip	100/Case
SCT10	Tray, Vinyl Gloves and 23 in. Suction Catheter	10 Fr	DeLee Tip	100/Case
SCT12	Tray, Vinyl Gloves and 23 in. Suction Catheter	12 Fr	Whistle Tip	100/Case
SCT14	Tray, Vinyl Gloves and 23 in. Suction Catheter	14 Fr	Whistle Tip	100/Case
SCT16	Tray, Vinyl Gloves and 23 in. Suction Catheter	16 Fr	Whistle Tip	100/Case

Suction Catheter Kits



Suction Catheter Kits

AMSure® Suction Catheter Kits provide hassle-free and convenient extraction of mucus or saliva from the upper respiratory airway.

- **Uniquely designed two-eyed whistle tip offers safe and effective suctioning**
- **Sterile, BPA-free, not manufactured with natural rubber latex**

ITEM	DESCRIPTION	CATHETER SIZE	FEATURES	QTY/UNIT
AS371	17 ½ in. (44.5 cm) Whistle Tip Catheter	6 Fr	1 Vinyl Glove	50/Case
AS381	17 ½ in. (44.5 cm) Whistle Tip Catheter	6 Fr	2 Vinyl Gloves	50/Case
AS372	17 ½ in. (44.5 cm) Whistle Tip Catheter	8 Fr	1 Vinyl Glove	50/Case
AS382	17 ½ in. (44.5 cm) Whistle Tip Catheter	8 Fr	2 Vinyl Gloves	50/Case
AS373	23 in. (58.4 cm) Whistle Tip Catheter	10 Fr	1 Vinyl Glove	50/Case
AS383	23 in. (58.4 cm) Whistle Tip Catheter	10 Fr	2 Vinyl Gloves	50/Case
AS374	23 in. (58.4 cm) Whistle Tip Catheter	12 Fr	1 Vinyl Glove	50/Case
AS384	23 in. (58.4 cm) Whistle Tip Catheter	12 Fr	2 Vinyl Gloves	50/Case
AS375	23 in. (58.4 cm) Whistle Tip Catheter	14 Fr	1 Vinyl Glove	50/Case
AS385	23 in. (58.4 cm) Whistle Tip Catheter	14 Fr	2 Vinyl Gloves	50/Case
AS376	23 in. (58.4 cm) Whistle Tip Catheter	16 Fr	1 Vinyl Glove	50/Case
AS386	23 in. (58.4 cm) Whistle Tip Catheter	16 Fr	2 Vinyl Gloves	50/Case
AS387	23 in. (58.4 cm) Whistle Tip Catheter	18 Fr	2 Vinyl Gloves	50/Case

RECEPTAL® & EZE-VAC® Reusable Hardware

Roll Stands

ITEM CODE	DESCRIPTION	QTY/UNIT
43474-01	Large head, stainless steel Adjustable Roll Stand, conductive casters, holds up to 12 RECEPTAL or 8 EZE-VAC Canisters, use with 1500 mL, 2000 mL and 3000 mL canisters	1/Case
43475-01	Small head, stainless steel Adjustable Roll Stand, conductive casters, holds multiple RECEPTAL and EZE-VAC Canisters	1/Case
43476-P2	Built-in Manifold with ON-OFF Valve Adjustable Roll Stand with 4 polycarbonate canister support, use with 1500 mL and 2000 mL canisters	1/Case
43476-P3	Built-in Manifold with ON-OFF Valve Adjustable Roll Stand with 4 polycarbonate canister support, use with 3000 mL canisters	1/Case



Single and In-Line Floor Stands

ITEM CODE	DESCRIPTION	QTY/UNIT
43431-01	Single Canister Floor Stand with tip-resistant base, use with 1500 mL and 2000 mL RECEPTAL Canisters	1/Case
43432-01	Dual Floor Stand, stainless steel with rollers and conductive casters, use with 1500 mL and 2000 mL RECEPTAL Canisters	1/Case
43447-01	In-Line Quad Floor Stand, stainless steel with rollers and conductive casters, use with 1500 mL and 2000 mL RECEPTAL Canisters	1/Case



RECEPTAL® & EZE-VAC® Reusable Hardware



RECEPTAL® Liner System Tandem Canister Supports

ITEM CODE	DESCRIPTION	QTY/UNIT
43429-01*	For 1500 mL and 2000 mL canisters	1/Case
43439-01	For 3000 mL canisters	1/Case



RECEPTAL® Liner System Single Canister Supports

ITEM CODE	DESCRIPTION	QTY/UNIT
43425-05*	For 1000 mL canister, metal	5/Case
43424-10	For 1000 mL canister support, with mounting plate, metal	5/Case
43426-05	For 1500 mL and 2000 mL canisters, metal	5/Case
43438-10	For 3000 mL canisters, with mounting plate for vacuum regulator, metal	10/Case
43428-05*	For 1500 mL and 2000 mL canisters, with mounting plate for vacuum regulator, metal	5/Case
43436-05	For 3000 mL canisters, metal	5/Case
43426P	For 1000 mL, 1500 mL, and 2000 mL canisters, plastic	20/Case
43436P	For 3000 mL canisters, plastic	10/Case
43424-V	For 1000/1500 mL canister support ring with valve	10/Case
43428-V	For 2000 mL canister support ring with valve	10/Case
43438-V	For 3000 mL canister support ring with valve	10/Case



EZE-VAC Rigid System Single Canister Supports

ITEM CODE	DESCRIPTION	QTY/UNIT
43467-01	For EZE-VAC 2.0 800 mL and 1200 mL canisters, metal, small: ID=4.4 in. (11.7 cm), wall to outer edge = 8.5 in. (21.6 cm)	12/Case
43469-12*	For EZE-VAC 1200 mL, 2000 mL and 3300 mL canisters, metal, large: ID=5.6 in. (14.2 cm), wall to outer edge = 9.4 in. (23.9 cm)	12/Case
43469-V	For EZE-VAC 1200 mL, 2000 mL, and 3300 mL with valve	10/Case

*Shown on Wall Bracket (Item 43444-05)

Canister Brackets

ITEM CODE	DESCRIPTION	QTY/UNIT
43444-05	Wall channel bracket for mounting canister, stainless steel	5/Case
43444P	Wall channel bracket for mounting canister, polycarbonate	50/Case
44303-10	Bracket Clamp Adapter for adapting Wall Bracket (43444-05) to fit stands, carts or vertical poles, stainless steel	10/Case
44304-05	Canister Support Bracket to attach Canister directly to a vacuum regulator, use with 1000 mL, 1200 mL and 1500 mL canisters	5/Case
RCB001	Metal Rail Bracket with Universal Holder Clamp	30/Case



Regulator Mounts

ITEM CODE	DESCRIPTION	QTY/UNIT
43408-05	Use to attach regulator alone or to other supports. 1/8 in. (0.32 cm) male pipe thread × 1/4 in. (0.64 cm) male taper with 1-1/8 in. (2.86 cm) threaded shank and 2 locknuts	5/Case
43422-05	Use when regulator is wall mounted to vacuum and a simple taper is needed to attach tubing to regulator. 1/8 in. (0.32 cm) male pipe thread × 1/4 in. (0.64 cm) male taper	5/Case
43401-05	Use to attach regulator alone or to other supports. 1/4 in. (0.64 cm) taper with 1-1/4 in. (3.18 cm) shank	5/Case
43400-05	Use when regulator is wall mounted to vacuum and a simple taper is needed to attach tubing to regulator. 1/4 in. (0.64 cm), male taper	5/Case
OFV001	Metal on-off valve, 1/8 in. NPT	25/Case



Note: Amsino does not sell Regulators

Waste Fluid Management Systems Installation

The basic components required for RECEPTAL® installation:

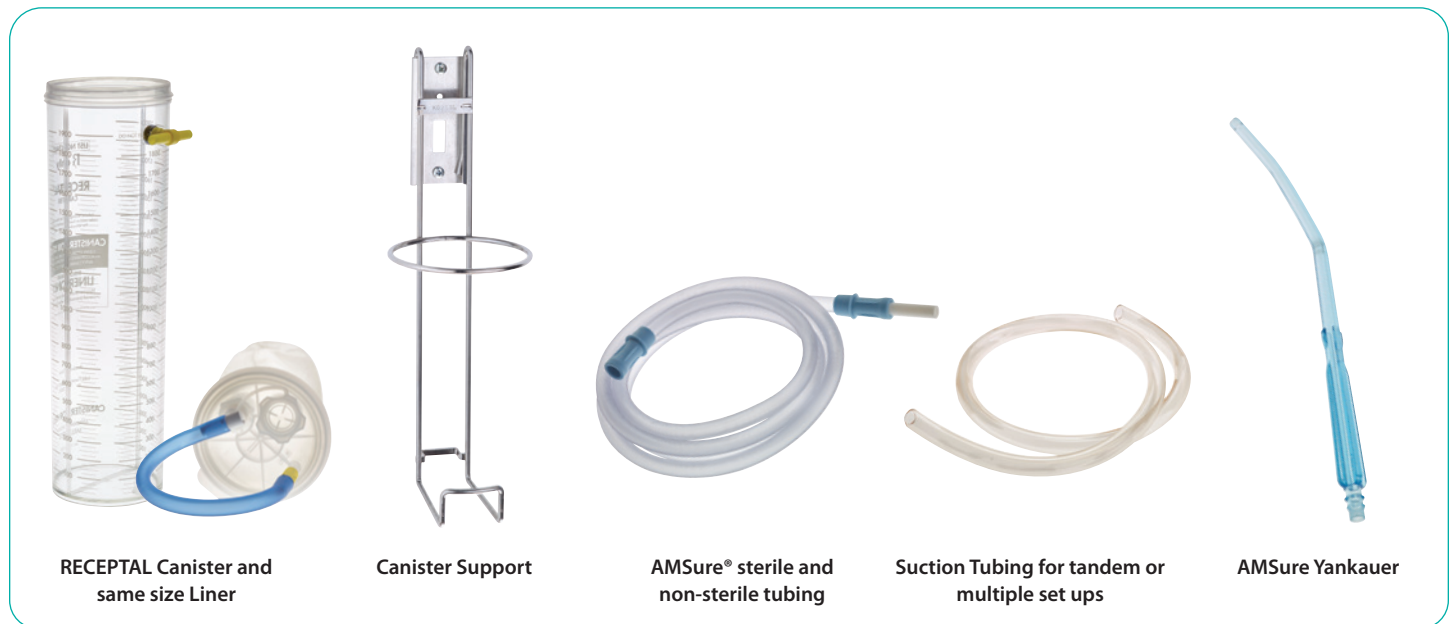

The single canister installation is used for simple or short procedures, not requiring a large waste suction volume.

RECEPTAL Single Canister and Liner Installation



1. Place canister into support.

2. Insert same size liner with VAC-GARD® and secure liner lid to canister.

3. Connect lid VAC-GARD® blue tubing and vacuum tubing to canister "T".

4. Connect patient tubing to patient port. Cap all ports not in use.

Waste Fluid Management Systems Installation

The basic components required for **EZE-VAC®** installation:



EZE-VAC Canister and Lid



Canister Support



AMSure® Sterile and
Non-Sterile Tubing



Tandem Tubing for tandem
or multiple set ups



AMSure Yankauer

EZE-VAC Single Canister Installation



1. Select canister size and secure lid to canister.



2. Select support.



3. Place canister in support, connect vacuum tubing to vacuum port elbow on lid.



4. Connect patient tubing to patient port elbow on lid. Cap all ports not in use.

Waste Fluid Management Systems Installation

When two or more canisters are required, the installation can be used by placing the canisters side-by-side, interconnected, via a piece of vacuum tubing.

RECEPTAL® Tandem Canister and Liner Installation



1. Select canister size and support. Place canisters into support.



2. Connect canister "T"s with vacuum tubing.



3. Insert same size liners (1 with and 1 without VAC-GARD®), secure liner lids to canisters.



4. Connect lid VAC-GARD® blue tubing and vacuum tubing to canister "T".



5. Connect lid tandem tubing (clear) to patient port of the lid with blue tubing.



6. Connect patient tubing to patient port. Cap all ports not in use.

Tandem Wall Mount Installation



For complete procedural installation, refer to Instructions For Use Guide

Waste Fluid Management Systems Installation

Multiple canisters are particularly suited for procedures that can generate high volumes of waste. The principle of multiple installation is the same as the tandem installation.

RECEPTAL® Multiple Canister and Liner Installation



1. Select canister size and supports. Attach supports to floor stand.



2. Insert canisters into supports.



3. Insert same size liners (1 with VAC-GARD® and remaining liners without), secure liner lids to canisters.



4. Interconnect canister "T"s with vacuum tubing. Attach the lid VAC-GARD® blue tubing and vacuum tubing to the remaining open "T" ports.



5. Connect lid tandem tubing (clear) to patient port of the lid with blue tubing. Repeat process until all liners are connected.



6. Connect patient tubing to patient port. Cap all ports not in use.

In-Line Quad Floor Stand Installation



For complete procedural installation, refer to Instructions For Use Guide

Waste Fluid Management Systems Installation

RECEPTAL® Manifold Trolley System Installation

- 1** Open the case, connect the main body of frame to floor stand.

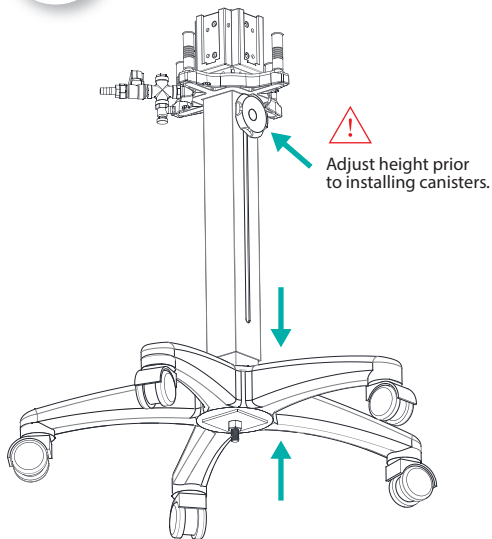

- 2** Insert canister into plastic canister support.

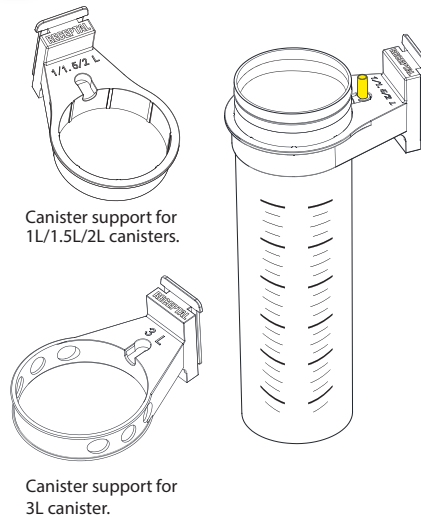

- 3** Insert canister support with canister into floor stand frame bracket.

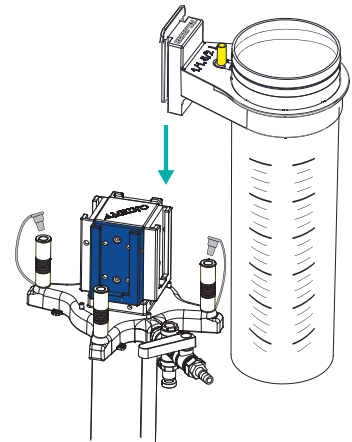

- 4** Insert additional canister supports with canisters into floor stand frame bracket.

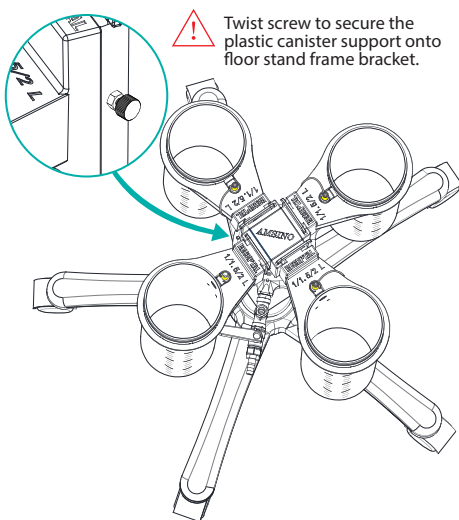

- 5** Straighten liner by pulling down and twisting prior to canister insertion.

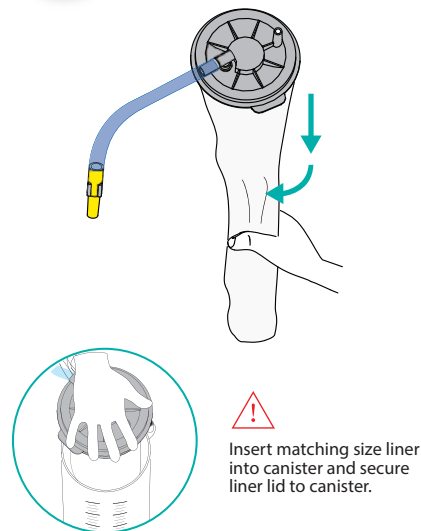

- 6** Connect liner lid tubing as shown, then turn on vacuum.

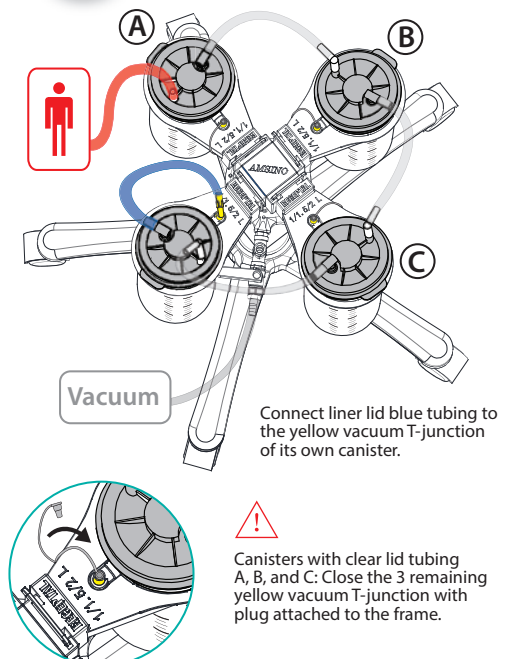

Waste Fluid Management Systems Installation

RECEPTAL® Manifold Trolley System Quick Reference Tips

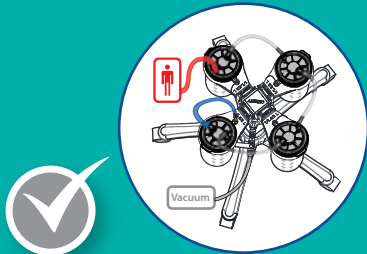

The system only works with negative pressure, verify suction prior to use. Connect tubing to the patient port and open the valve after complete canister/liner assembly.

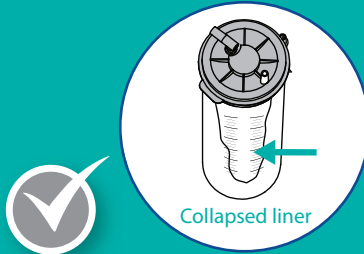

If liner collapses while working, check to ensure all port connections are tight or capped, and the liner lid is firmly sealed onto canister. If above fails, replace liner.

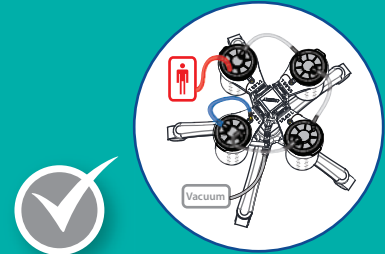

Leave vacuum on until end of the procedure, and cap all ports to avoid exposure.

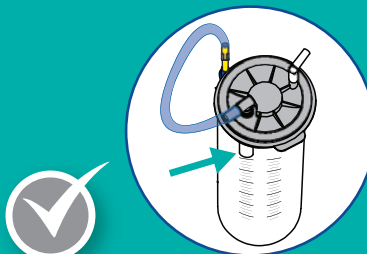

Prior to use, verify if the shut off valve of liner with blue tubing is installed correctly.

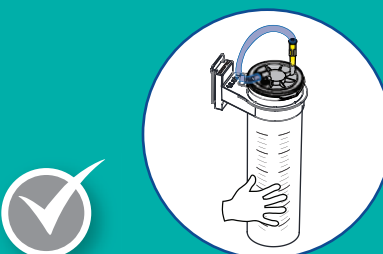

Disconnect liner tubing and immediately reconnect to its open port with push and twist motion (friction lock).

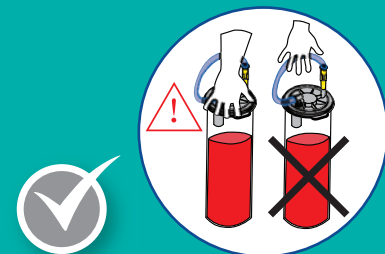

Do not use lid tubing as a handle to lift or carry liner.

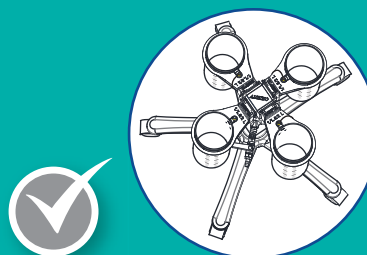

The canisters and floor stand can be cleaned, but the liners are single use.



Visit video library for set up video.

Waste Fluid Management Systems Installation

Multiple canisters are particularly suited for procedures that can generate high volumes of waste. The canisters are interconnected using EZE-VAC® tandem tubing.

EZE-VAC Multiple Canister Installation



1. Attach supports to floor stand. Select canister size and secure lids to canisters.



2. Place canisters into supports. Connect vacuum tubing to vacuum port elbow on lid. Secure vacuum port caps on remaining canisters.



3. Connect ortho port to adjacent patient port with tandem tubing (Item 43317-25). Repeat until all canisters are connected.



4. Connect patient tubing to patient port elbow on lid.

Waste Fluid Management Systems Installation

ON-OFF Valve Installation in RECEPTAL® Support Ring



1. Attach Regulator Mount (43408-05) to canister support ring.



2. Connect ON-OFF valve (OFV001) to Regulator Mount (43408-05).



3. Connect Regulator Mount (43422-05) to ON-OFF valve (OFV001).

ON-OFF Valve Installation in EZE-VAC® Support Ring



1. Attach Regulator Mount (43408-05) to canister support ring.



2. Connect ON-OFF valve (OFV001) to Regulator Mount (43408-05).

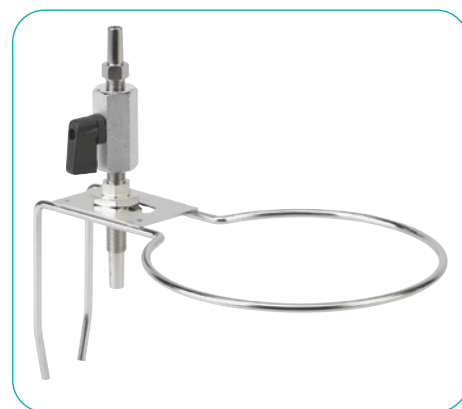

3. Connect Regulator Mount (43422-05) to ON-OFF valve (OFV001).

Waste Fluid Management Systems Installation

RECEPTAL® Multiple Canister and Liner Installation with ON-OFF Valves



1. Attach supports rings with ON-OFF valves to floor stand.



2. Insert canisters into supports.



3. Connect tube manifold to vacuum "T"s of each canisters. Connect vacuum source to tube manifold.



4. Connect vacuum "T"s to ON-OFF valve ports with connecting tube (Item CTM20B). Repeat until all canisters are connected.

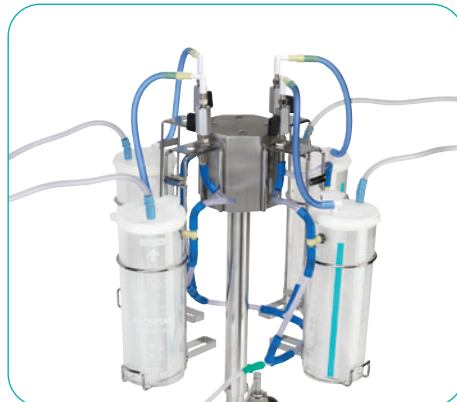

5. Insert same size liners, and secure liner lids to canisters. For better suction power in canisters in use, switch OFF the valves of the canisters not in use. Example above is for four (4) suctions at the same time, therefore all liners must have VAC-GARD®.



TANDEM CONNECTION SET-UP: Example is for two (2) suctions. Insert same size liners (2 with VAC-GARD® and 2 liners without), secure liner lids to canisters. Connect lid tandem tubing (clear) to patient port of the lid with blue tubing, and switch OFF the valves of liners with clear tube. Connect blue tubing to ON-OFF valve of respective canister. Connect patient tubing to patient port.

Additional Comments

- Set-up for metal floor stand.
- Cap any port not in use.
- Amsino recommends exercising universal precautions during handling and disposal.
- Do not use lid tubing as a handle to lift or carry liner.

Waste Fluid Management Systems Installation

EZE-VAC® Multiple Canister Installation with ON-OFF Valves



1. Attach supports rings with ON-OFF valves to floor stand. Select canister size and secure lids to canisters.

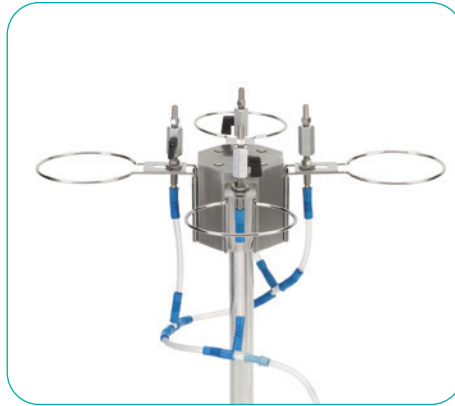

2. Connect tube manifold to ON-OFF valves of each canister support ring. Connect vacuum source to tube manifold.



3. Place canisters into support rings. Secure ortho/tandem port caps on all canisters.



4. Connect vacuum port to ON-OFF valve port with tandem tubing (Item 43317-25). Repeat until all canisters are connected. Example above is for four (4) suctions.



5. Connect patient tubing to patient port elbow on lid of each canister in use. For better suction power in canisters in use, switch to OFF the valve of the canisters not in use.



TANDEM CONNECTION SET-UP
Connect ortho/tandem port to adjacent patient port with tandem tubing (Item 43317-25). Repeat for necessary tandem connections. Secure vacuum port caps not in use. Example above is for two (2) suctions.

Additional Comments

- The canister and lid are disposable and intended for single use.
- The suction power is defined by the vacuum source, not the canister system. The more open suctions at the same time, the less suction power in each patient port. The suction power divides by the number of open suctions at the same time.
- Amsino recommends exercising universal precautions during handling and disposal.

Waste Fluid Management Systems Installation

External VAC-GARD® Installation



1. Select RECEPTAL canister size and same size liner without integrated VAC-GARD blue tubing. Insert external VAC-GARD onto canister "T".



2. Attach lid tubing to external VAC-GARD. Connect vacuum tubing to canister "T".



3. Connect patient tubing to patient port. Cap all ports not in use.

RECEPTAL® ACCU-MEASURE® Installation



1. Select RECEPTAL canister size and attach ACCU-MEASURE bracket.



2. Slide 250 mL ACCU-MEASURE device onto bracket.



3. Follow RECEPTAL single liner set-up. Use tandem tubing to connect vacuum port of ACCU-MEASURE to patient port of liner lid.



4. Connect patient tubing to ACCU-MEASURE patient port. Cap all ports not in use.

For complete procedural installation, refer to Instructions For Use Guide

Uninstallation Procedures

RECEPTAL® Liner Uninstallation Procedure



1. Leave vacuum switched on at the end of the procedure.

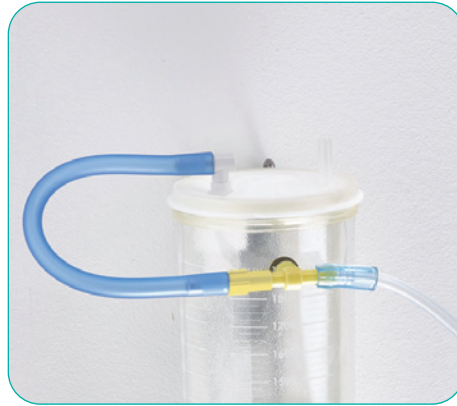

2. Remove patient suction tubing from patient port and discard.



3. Disconnect liner lid tubing from canister "T" and immediately reconnect to patient port with push and twist motion (friction lock).

Additional Comments

- Cap any port not in use.
- Do not use lid tubing as a handle to lift liner.
- Amsino recommends exercising universal precautions during handling and disposal.

EZE-VAC® Canister Uninstallation Procedure



1. Remove patient and vacuum tubing.



2. Cap all ports with tethered caps provided.

Additional Comments

- The canister and lid are disposable and intended for single use.
- Amsino recommends exercising universal precautions during handling and disposal.

Index

Item Number	Page	Item Number	Page	Item Number	Page
0L655-01	2	43316-01	13	43503-01	1
0L656-01	2	43317-25	12	44300-05	13
43010-05	2	43318-01	13	44303-10	18
43010S	2	43400-05	18	44304-05	18
43015S	2	43401-05	18	AS361	14
43020S	2	43408-05	18	AS361C	14
43025-01	2	43422-05	18	AS362	14
43027-01	2	43423-01	1	AS362C	14
43030S	2	43424-10	17	AS364	14
43041-01	2	43424-V	17	AS364C	14
43042-01	2	43425-05	17	AS365	14
43044-01	2	43426-05	17	AS365C	14
43044-05	2	43426P	17	AS366	14
4305SP	4	43428-05	17	AS366C	14
4305SB	4	43428-V	17	AS367	14
43110S	3	43429-01	17	AS367C	14
43115S	3	43431-01	16	AS371	15
43116S	3	43432-01	16	AS372	15
43120S	3	43436-05	17	AS373	15
43121S	3	43436P	17	AS374	15
4312SP	4	43438-10	17	AS375	15
4312SB	4	43438-V	17	AS376	15
4315SP	4	43439-01	17	AS381	15
4315SB	4	43444-05	18	AS482	15
43160SB	4	43444P	18	AS383	15
4320SP	4	43445-01	1	AS384	15
4320SB	4	43447-01	16	AS385	15
43202-01	6	43448-25	13	AS386	15
43202-820821	6	43449-05	1	AS387	15
43203-01	5	43455-01	12	AS807	13
43206-01	5	43457-25	12	AS807B	13
43210-01	6	43467-01	17	AS820	10
43213-01	5	43468-01	16	AS820B	10
4330SP	4	43469-12	17	AS821	10
4330SB	4	43469-V	17	AS821B	10
43303-01	11	43473-25	13	AS822	10
43303-02	11	43474-01	16	AS822B	10
43303-05	11	43475-01	16	AS823	10
43305-10	11	43476-P2	16	AS823B	10
43306-01	7	43476-P3	16	AS824	10
43309-01	11	43494-25	13	AS824B	10

Item Number	Page
AS825	10
AS825B	10
AS825BM	10
AS825M	10
AS825P	8
AS826	10
AS826B	10
AS826BM	10
AS826C	10
AS826M	10
AS827	10
AS827B	10
AS827BM	10
AS827M	10
AS828	10
AS828B	10
AS829B-01	10
AS828BM	10
AS828M	10
AS830	8
AS831	8
AS832	8
AS833	8
AS834	8
AS835	8
AS836	8
AS837	8
CTM20B	12
CTM50B	12
OFV001	18
RCB001	17
SCT08	14
SCT10	14
SCT12	14
SCT14	14
SCT16	14
SIH0001	9
TMF001	12
UYC001	13
UYC001S	13

Your local Distributor

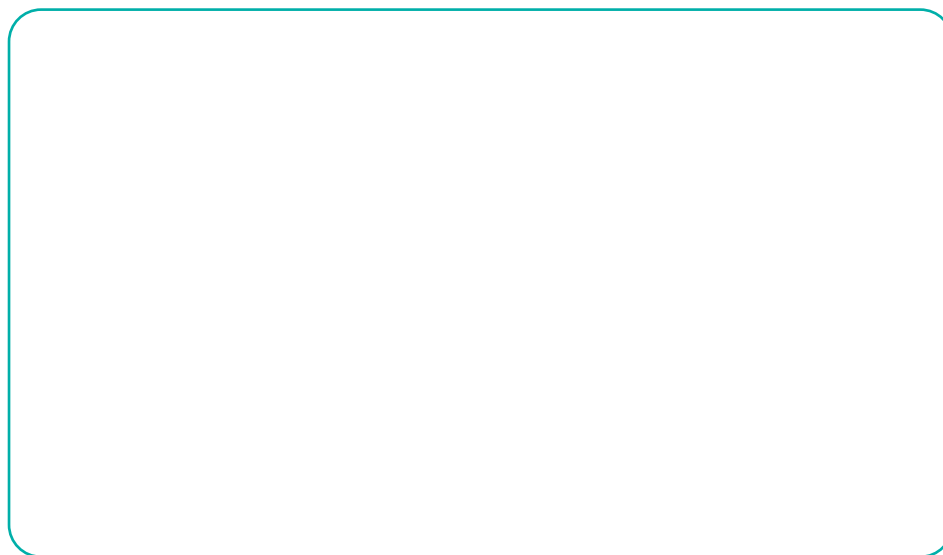

For more information visit www.amsino.com

Amsino International, Inc.

708 Corporate Center Drive, Pomona, CA 91768

800.632.6746 • fax: 909.626.3888 • info@amsino.com • Online catalog at www.amsino.com

© Copyright 2023, Amsino International, Inc. All rights reserved. This catalog, or any part thereof, may not be reproduced in any form without written permission. Printed in USA.

AMSINO

Advancing Healthcare Worldwide®